

Order no.	Version	Appli- cation	PN	DN	Thread	PE pipe Ø mm	
2681	ISO Combination Tapping Valve DN 1" with 2" male iron thread for mounting onto saddle and 1½" male iron thread <u>only for</u> ISO push-fit fitting No. 6221F (without ISO push-fit fitting)	cold water other applications on request	16	1"	2" - 1½"		●
2680	ISO Combination Tapping Valve DN 1" with 2" male iron thread for mounting onto saddle and 1½"male iron thread <u>only for</u> ISO push-fit fitting No. 6221F (complete with choice of ISO push-fit fitting)			1"	2" - 1½"	25	●
						32	●
						40	●
						50	●
						63	●
6221F	ISO push-fit fitting with backing washer			1½"	25	●	
					32	●	
					40	●	
					50	●	
					63	●	
5940	Adaptor for HAWLE drilling machine (2")			1½" - 2"		●	

- One valve with 5 ISO push-fit fittings for PE pipes (pipe Ø 25/32/40/50/63 mm) - reduces stockkeeping
- A robust valve of POM
- For the easiest under pressure tapping and the quickest installation of ISO push-fit fittings

For technical details and instructions for use, see over page.

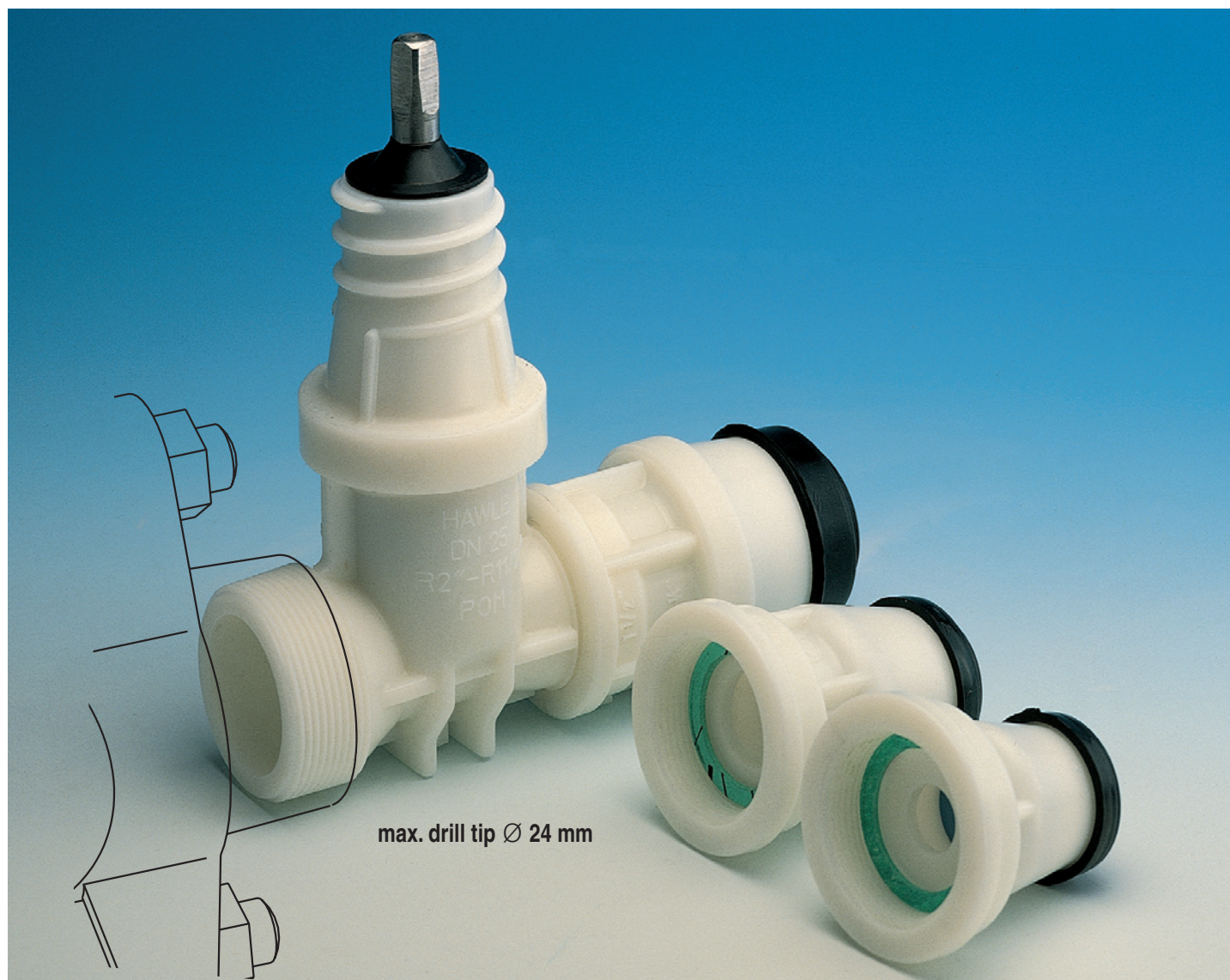

ISO Combination Tapping Valve

Suitable handwheel: No. 7800
Suitable extension spindles: rigid No. 9101,
 telescopic: No. 9601

Suitable surface boxes: rigid No. 1550 light duty,
 rigid No. 1650 heavy duty,
 telescopic: No. 1850, No. 1851K

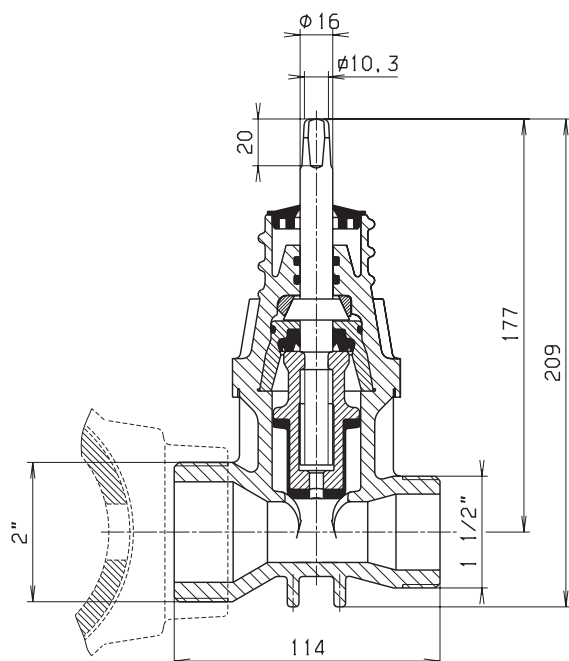

No. 2681

Tapping Valve DN 1"

with 2" external thread EN 10226-1 for mounting onto saddle

and 1½" external thread ISO 228 only for ISO push-fit fitting No. 6221F

Sealing system:

The contact between wedge and body is friction free. Therefore no scuffing or abrasion of the wedge.

Material:

Body: POM
 tensile strength 7000 N/cm²

Wedge: CuZn39Pb3 (Ms 58)
 wedge rubber of elastomer, suitable for potable water

Spindle: stainless steel min. 1.4021 (X20Cr13)

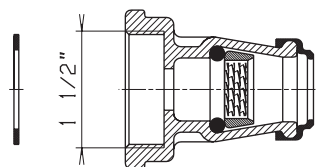

No. 6221F

ISO push-fit fitting

POM

internal thread 1½" ISO 228

push-fit socket for PE pipes up to PN 16, pipe Ø 25/32/40/50/63 mm

The backing washer (made of Aqua-Gummi) eliminates time-consuming sealing with hemp or PTFE tape.

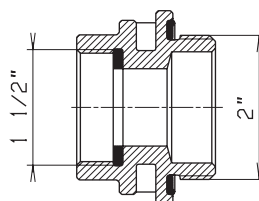

No. 5940

Adaptor

G-CuSn7ZnPb (Rg7)

internal thread 1½" ISO 228
 external thread 2" ISO 228

for HAWLE drilling machines
 No. 5800 or No. 5805

DRILLING AND ASSEMBLY INSTRUCTIONS

1. Mounting onto the saddle:

Screw the 2" external thread into the internal thread of the saddle.

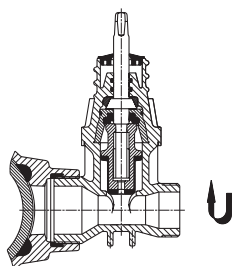

2. Drilling:

Open the valve completely; if necessary use adaptor no. 5940.

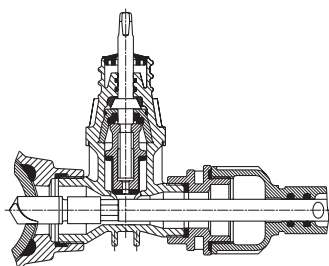

3. Shut off:

After drilling, retract the drill and close the valve.

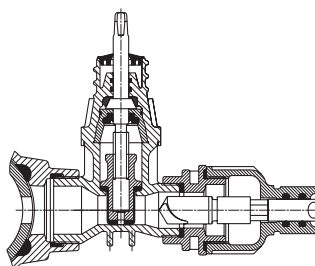

4. Pipe assembly:

Screw on one of the three ISO push-fit fittings — push the pipe in — finished.

